

LOAD AND RESISTANCE FACTOR RATING (LRFR) SUMMARY FOR PRESTRESSED CONCRETE GIRDERS																							
LOAD TYPE	VEHICLE	WEIGHT (W) (TONS)	CONTROLLING LOAD RATING ⬡#	MINIMUM RATING FACTORS (RF)	TONS = W x RF	STRENGTH I LIMIT STATE										SERVICE III LIMIT STATE							
						LIVE-LOAD FACTORS (γ LL)	MOMENT					SHEAR					LIVE-LOAD FACTORS (γ LL)	MOMENT					COMMENT NUMBER
							DISTRIBUTION FACTORS (DF)	RATING FACTOR	SPAN	GIRDER LOCATION	DISTANCE FROM LEFT END OF SPAN (ft)	DISTRIBUTION FACTORS (DF)	RATING FACTOR	SPAN	GIRDER LOCATION	DISTANCE FROM LEFT END OF SPAN (ft)		DISTRIBUTION FACTORS (DF)	RATING FACTOR	SPAN	GIRDER LOCATION	DISTANCE FROM LEFT END OF SPAN (ft)	
DESIGN LOAD	HL-93 (INVENTORY)	N/A	⬡1	1.006	--	1.75	0.273	1.03	70'	EL	34.5	0.507	1.32	70'	EL	6.9	0.80	0.273	1.01	70'	EL	34.5	
	HL-93 (OPERATING)	N/A		1.341	--	1.35	0.273	1.34	70'	EL	34.5	0.507	1.72	70'	EL	6.9	N/A	--	--	--	--	--	
	HS-20 (INVENTORY)	36.000	⬡2	1.306	47.02	1.75	0.273	1.34	70'	EL	34.5	0.507	1.65	70'	EL	6.9	0.80	0.273	1.31	70'	EL	34.5	
	HS-20 (OPERATING)	36.000		1.740	62.64	1.35	0.273	1.74	70'	EL	34.5	0.507	2.14	70'	EL	6.9	N/A	--	--	--	--	--	
LEGAL LOAD	SINGLE VEHICLE (SV)	SNSH		2.917	39.379	1.4	0.273	3.75	70'	EL	34.5	0.507	4.87	70'	EL	6.9	0.80	0.273	2.92	70'	EL	34.5	
		SNGARBS2		2.187	43.741	1.4	0.273	2.81	70'	EL	34.5	0.507	3.47	70'	EL	6.9	0.80	0.273	2.19	70'	EL	34.5	
		SNAGRIS2		2.077	45.690	1.4	0.273	2.67	70'	EL	34.5	0.507	3.23	70'	EL	6.9	0.80	0.273	2.08	70'	EL	34.5	
		SNCOTTS3		1.452	39.565	1.4	0.273	1.87	70'	EL	34.5	0.507	2.43	70'	EL	6.9	0.80	0.273	1.45	70'	EL	34.5	
		SNAGGRS4		1.218	42.554	1.4	0.273	1.57	70'	EL	34.5	0.507	2.03	70'	EL	6.9	0.80	0.273	1.22	70'	EL	34.5	
		SNS5A		1.191	42.346	1.4	0.273	1.53	70'	EL	34.5	0.507	2.06	70'	EL	6.9	0.80	0.273	1.19	70'	EL	34.5	
		SNS6A		1.095	43.747	1.4	0.273	1.41	70'	EL	34.5	0.507	1.88	70'	EL	6.9	0.80	0.273	1.10	70'	EL	34.5	
		SNS7B		1.043	43.801	1.4	0.273	1.34	70'	EL	34.5	0.507	1.85	70'	EL	6.9	0.80	0.273	1.04	70'	EL	34.5	
	TRUCK TRACTOR SEMI-TRAILER (TTST)	TNAGRIT3		1.336	44.087	1.4	0.273	1.72	70'	EL	34.5	0.507	2.23	70'	EL	6.9	0.80	0.273	1.34	70'	EL	34.5	
		TNT4A		1.342	44.401	1.4	0.273	1.72	70'	EL	34.5	0.507	2.17	70'	EL	6.9	0.80	0.273	1.34	70'	EL	34.5	
		TNT6A		1.100	45.746	1.4	0.273	1.41	70'	EL	34.5	0.507	1.98	70'	EL	6.9	0.80	0.273	1.10	70'	EL	34.5	
		TNT7A		1.106	46.462	1.4	0.273	1.42	70'	EL	34.5	0.507	1.94	70'	EL	6.9	0.80	0.273	1.11	70'	EL	34.5	
		TNT7B		1.147	48.180	1.4	0.273	1.47	70'	EL	34.5	0.507	1.80	70'	EL	6.9	0.80	0.273	1.15	70'	EL	34.5	
		TNAGRIT4		1.089	46.838	1.4	0.273	1.40	70'	EL	34.5	0.507	1.74	70'	EL	6.9	0.80	0.273	1.09	70'	EL	34.5	
		TNAGT5A		1.026	46.175	1.4	0.273	1.32	70'	EL	34.5	0.507	1.74	70'	EL	6.9	0.80	0.273	1.03	70'	EL	34.5	
		TNAGT5B	⬡3	1.013	45.579	1.4	0.273	1.30	70'	EL	34.5	0.507	1.66	70'	EL	6.9	0.80	0.273	1.01	70'	EL	34.5	
EMERGENCY VEHICLE (EV)	EV2	28.750		1.816	52.212	1.3	0.273	2.11	70'	EL	34.5	0.507	2.59	70'	EL	6.9	0.80	0.273	1.82	70'	EL	34.5	
	EV3	43.000	⬡4	1.188	51.068	1.3	0.273	1.38	70'	EL	34.5	0.507	1.75	70'	EL	6.9	0.80	0.273	1.19	70'	EL	34.5	

LOAD FACTORS:

DESIGN LOAD RATING FACTORS	LIMIT STATE	γ DC	γ DW
	STRENGTH I	1.25	1.50
	SERVICE III	1.00	1.00

NOTES:

MINIMUM RATING FACTORS ARE BASED ON THE STRENGTH I AND SERVICE III LIMIT STATES.

ALLOWABLE STRESSES FOR SERVICE III LIMIT STATE ARE AS REQUIRED FOR DESIGN.

⬡# CONTROLLING LOAD RATING

⬡1 DESIGN LOAD RATING (HL-93)

⬡2 DESIGN LOAD RATING (HS-20)

⬡3 LEGAL LOAD RATING **

⬡4 EMERGENCY VEHICLE LOAD RATING **

** SEE CHART FOR VEHICLE TYPE

GIRDER LOCATION

I - INTERIOR GIRDER
EL - EXTERIOR LEFT GIRDER
ER - EXTERIOR RIGHT GIRDER

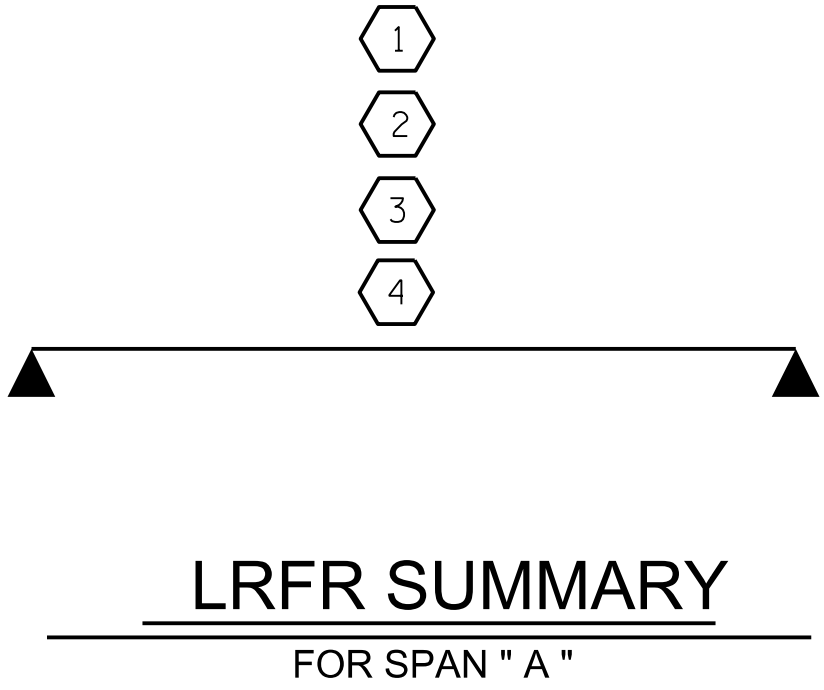

PROJECT NO. DF18314.2044195

HAYWOOD COUNTY

STATION: 13+39.86 -L-

DES BY: <u>D. MAST</u>	DATE : <u>03/25</u>	DWG BY: <u>B. PETERSON</u>	DATE : <u>03/25</u>
DES CHK: <u>A. ABERNATHY</u>	DATE : <u>03/25</u>	CHK BY: <u>D. MAST</u>	DATE : <u>03/25</u>

HDR Engineering, Inc. of the Carolinas
555 Fayetteville St., Suite 900 Raleigh, N.C. 27601
N.C.B.E.L.S. License Number: F-0116

12/15/2025

DOCUMENT NOT CONSIDERED FINAL
UNLESS ALL SIGNATURES COMPLETED



STATE OF NORTH CAROLINA
DEPARTMENT OF TRANSPORTATION
RALEIGH

LRFR SUMMARY FOR
70' CORED SLAB UNIT
90° SKEW
(NON-INTERSTATE TRAFFIC)

REVISIONS						SHEET NO. S-05
NO.	BY:	DATE:	NO.	BY:	DATE:	
1	--	--	3	--	--	TOTAL SHEETS 18
2	--	--	4	--	--	